

Electrotech

Tel: (215) 997-8855

www.esgllc-usa.com

Flexible – Quick Connection Power Bus

For Conveyor Applications

IP68 rated (wash down approved)



Quickly connect Box used for supply and branching

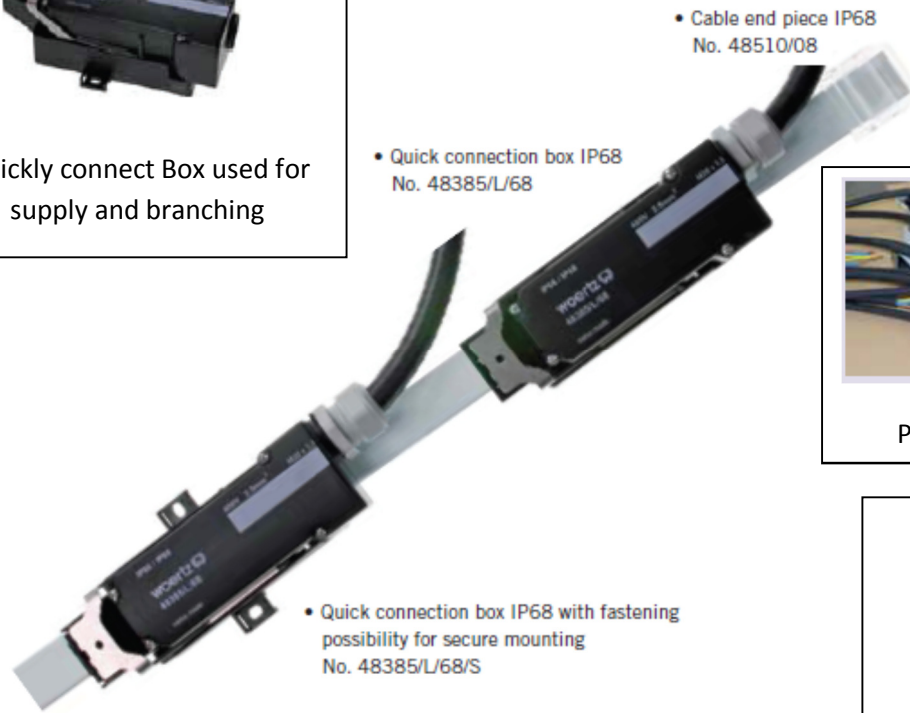

• Cable end piece IP68
No. 48510/08

• Quick connection box IP68
No. 48385/L/68

• Quick connection box IP68 with fastening possibility for secure mounting
No. 48385/L/68/S



Pre-wired boxes available



49863/FRNC

Cable – 5 x 2.5mm
(14 AWG)

Woertz's Flexible – Quick connect Power Bus is well suited for feeding power along a conveyor line. The IP68 rated power bus system can be used in wash down areas without any special enclosures. The flat cable seen above has 5 conductors (3L + N + PE) and can be used in 1-phase, 3-Phase applications, or as a Dual DC bus (12VDC and 24VDC) to energize sensors. The cable is rated for 20 Amps / 600V. Feed-in and junction boxes are quickly connected anywhere along the length of the cable without cutting the cable. The Woertz connection boxes are keyed and energized with insulation displacement screws.

This Power Bus System will reduce the amount of wire used and can power multiple devices along the conveyor line - motor control junction boxes, sensors, lights, etc. The equipment can be bought individually or as a "KIT" with defined cable lengths and pre-wired feed-in and junction boxes.

Electrotech

Tel: (215) 997-8855

www.esgllc-usa.com

Other cable sizes are available. Please contact us for more information.



Specifications:

	5G2.5mm ² (Quick connect)	5G16mm ² (high power)
	 3LxNxPE	 3LxNxPE
Part No.	49863/FRNC	49605
Technical data-Flat cable		
Dimension (mm/inches)	24x6	48.5x11.3
Weight (g/m)	247	1300
Fire load (kWh/m)	0.671	2.95
No. of leads x cross section(mm ² /AWG)	5x2.5 (14 AWG)	5x16 (6AWG)
Power current		
Copper conductors	Tinned, highly flexible	Bare, highly flexible
Insulation of leads	Vulcanized and flame retardant polyethylene	PVC
Color of leads	grey,black,brown,blue,green/yellow	Brown,blue,green/yellow,black,grey
Cross section (mm ² /AWG)	2.5 (14 AWG)	16mm ² (6AWG)
Test voltage (V)	4000 V	4000V
Rated voltage (kV)	600V	600V
Max temp rating	-15°C +90°C	
Min. insulation temp	+5°C	
Bending radius	Min 6x cable thickness	
Connection Box Quick connect box for supply and branching	 IP68	 IP68 Connection Box Branching Box
Part No.	48385/L/68	49615 49616
Fastening version	48385/L/68/S	
Cross section	2.5mm (14AWG)	16mm ² (6AWG)
Rated voltage	400V	690V
Current rating	24 Amps	63 Amps
Cable gland	 48560/03/M20	 49628 (M2.5x1/5)