



2.2 Multifunction Time Relays
CIM1, CIM1R

Multifunction | 24 ... 240 V UC | 1 CO

Time data	fig. 1 1:-E 2:-A, K, N, B1, S, LS 3:-B, W 50 ms ... 60 h 0.6 s / 6 s / 60 s / 6 min / 60 min / 6 h / 60 h
Main circuit	1 CO
Number of contacts	AGNI
Contact Material	250 V AC
Rated voltage	16 A
Rated current	10 mA, 10 V
Minimum load	30 A, 10 ms
Inrush current	fig. 2
Rated load DC	4000 VA
Rated load AC-1	3 x 10 ⁷
Mechanical endurance (cycles)	fig. 3
Electrical endurance at rated load AC-1 (cycles)	

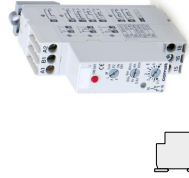

fig. 1. Wiring diagram

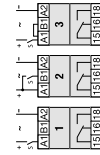

fig. 2. DC load limit curve

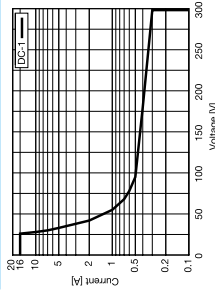

fig. 3. AC voltage endurance

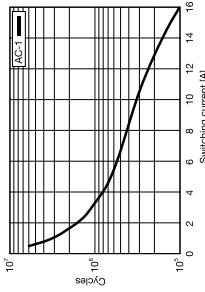
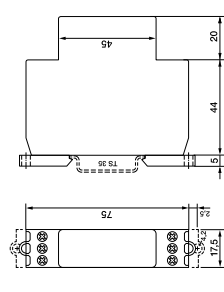

fig. 4. Dimensions (mm)



Standards and approvals

Standards IECEN 60947, IECEN 50155
Approvals

Product references

Types	Product reference	24-240
UC supply	CIM1/UC...V	✓
UC supply, Railway version	CIM1R/UC...V	✓

... list control circuit voltage to complete product references.
Other voltages on request. Please contact support@comatreleco.com.

2.2 Multifunction Time Relays
CIM12, CIM12R

Multifunction | 24 ... 240 V UC | 1 Triac

Time data	fig. 1 1:-E 2:-A, K, N, B1, S, LS 3:-B, W 50 ms ... 60 h 0.6 s / 6 s / 60 s / 6 min / 60 min / 6 h / 60 h
Main circuit	1 NO
Number of outputs	Triac, zero crossing
Output type	250 V AC
Rated voltage	2 A
Rated current	50 mA, 12 V
Minimum load	100 A, 10 ms
Inrush current	78 A ² s
Rated limit load	1 mA
Typ. leakage current	300 VA
Rated load AC-1	∞
Mechanical endurance (cycles)	∞
Electrical endurance at rated load AC-1 (cycles)	

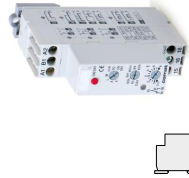

fig. 1. Wiring diagram

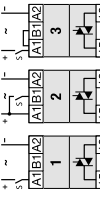
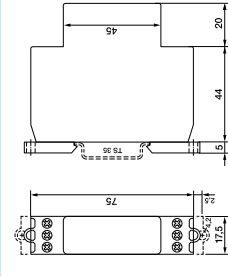

fig. 2. Dimensions (mm)



Standards and approvals

Standards IECEN 60947, IECEN 50155
Approvals

Product references

Types	Product reference	24-240
UC supply	CIM12/UC...V	✓
UC supply, Railway version	CIM12R/UC...V	✓

... list control circuit voltage to complete product references.
Other voltages on request. Please contact support@comatreleco.com.